

COVID-19 COACH CHECKLIST

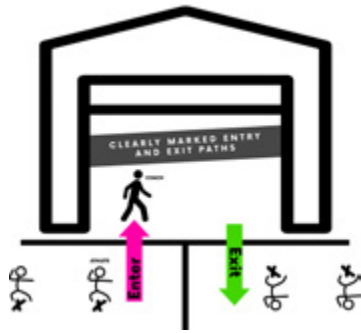

VENUE CHECKS:

- Start of Day Cleaning Completed.
- All Social Distancing Marks Visible.
- Entry & Exit's Clearly Marked.
- Hand sanitiser & cleaning equipment in place.
- Final Venue Check Done – everything as it should be



ENTRY PROCEDURES:

- Additional staff member rostered and present at entry point to greet, take attendance, sanitise and check masks are fitted properly.
- Coach to go through health & safety rules enforcing social distancing guidelines.
- Coach to be waiting at the front of the floor as athletes arrive, to help them to a square/mark.

HEALTH & SAFETY REMINDERS:

- Sorry no social contact - no hugs high fives or handshakes (until level 1)
- No more than one person at the toilet at a time.
- Use the arrows and marked spaces to ensure social distancing while moving throughout the venue.
- Cough or Sneeze into your elbow
- Wash and Sanitize hands often
- When practice is over athletes will be released one at a time by their coaches
- Must use personal labeled drink bottle



END OF CLASS PROCEDURE:

- Coach to wait at exit point for parents to arrive.
- Coach to call athletes off the floor and release them to their parent.
This will be done to avoid athletes and parents congregating.
- Another coach to stay on the floor with athletes to ensure social distancing guidelines are followed
- Remind athletes to hand sanitize on exit.
- Remind athletes to take all their belongings – nothing should be left behind.
- All high touch point areas to be sanitized between classes.
- Or if last class end of class cleaning to be completed



COVID-19 GYM CLEANING CHECKLIST



If you are rostered on for cleaning please complete & tick off the following. Please ensure you wear the provided gloves, masks are available if you would like them. And a reminder to ensure you maintain social distancing when cleaning.

BEFORE CLASS STARTS:



- Vacuum** all floors
- General tidy** including removing any clothing, loose items or other debris from gym
- Empty all **rubbish** bins
- Sanitise** high touch surfaces, including door knobs, hand rails, etc.
- Clean & Sanitise** Bathrooms
- Mop/Disinfect** bathroom floors as well as any other high traffic hard surfaces (Entries, exits, offices)

DURING CLASS:



- Sanitise** all high touch surfaces
- Sanitise** & clean any equipment that may have been used including Tumble Trak, Trampolines.
- Sanitise** & clean all staff equipment including:
ipads, music players, bluetooth speakers, white boards, marker pens etc

AFTER LAST CLASS:

- Sanitise/Disinfect** anything that may have been used including all gym & staff equipment
- Put away any and all **equipment**
- Spray Cheer Floors** with disinfectant and leave over night to dry

